

Sample Question Paper

General Instructions

- All questions are compulsory.
- The question paper consists of 35 questions divided into four sections - A, B, C and D.
- Section A comprises of **10 Logical Reasoning** questions of **one mark** each.
Section B comprises of **10 Mathematical Reasoning** questions of **one mark** each
Section C comprises of **10 Everyday Math** questions of **one mark** each
Section D (Achievers Section) comprises of **5 HOTS** questions of **two marks** each.
- All questions are Multiple Choice Question type.
- Each question has four options marked (a), (b), (c) and (d). You have to choose the correct or most appropriate answer by bubbling the OMR Sheet.
- The duration of the test is **60 minutes**.

SECTION A : LOGICAL REASONING

1. Find the missing number.

538, 518, —, 484, 470, 458, 448

- a) 508 b) 494 c) 500 d) 480

2. Find the mirror image of the figure given below, if the mirror is placed vertically to the right.

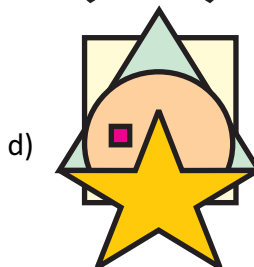
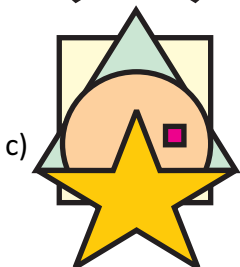
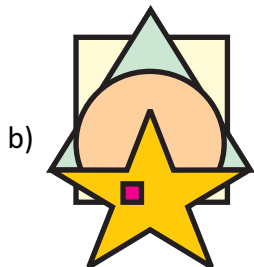
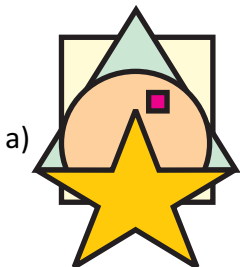
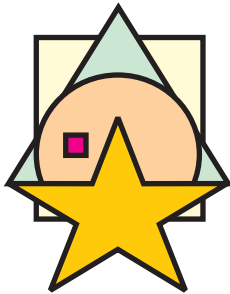

3. Which of the following figure will replace the question mark?

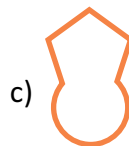
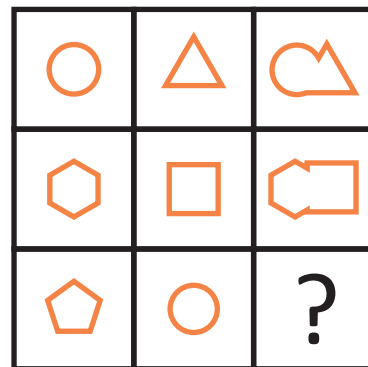

4. Which of the following will come in place of the question mark?

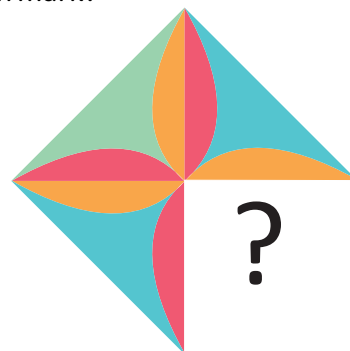

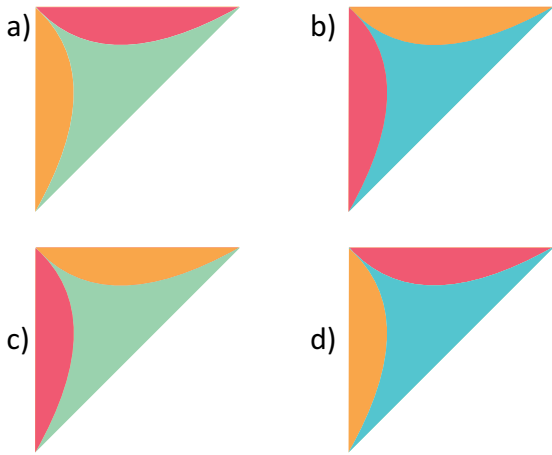

5. If there are 4 circles around one circle, 6 cells around two circles in a row, then the number of cells around a row of three circles is _____.

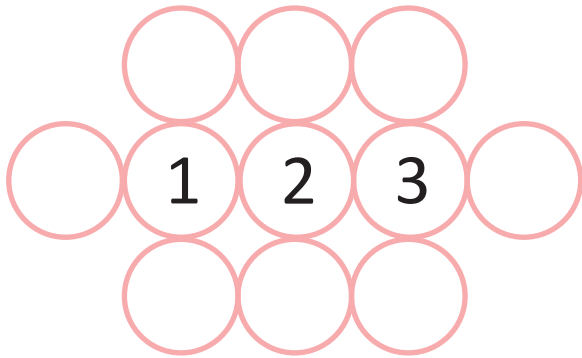

- a) 6 b) 8 c) 10 d) 12

6. Which of the following letter will come next?

aBc abC Abc dEf deF Def ...

- a) hij b) hlj c) Hij d) hiJ

7. The given letters are numbered 1, 2, 3, 4, etc., Find the combination of numbers so that the letters arranged accordingly to form a meaningful word.

- a) 5, 4, 3, 2, 1 b) 3, 4, 5, 2, 1
c) 4, 3, 5, 2, 1 d) 4, 5, 3, 2, 1

8. Deena holds 33rd rank from bottom in a class of 42 students. What is her rank from the top?

T U O S H
1 2 3 4 5

- a) 6th b) 10th c) 11th d) 7th

9. In which direction is the school located?

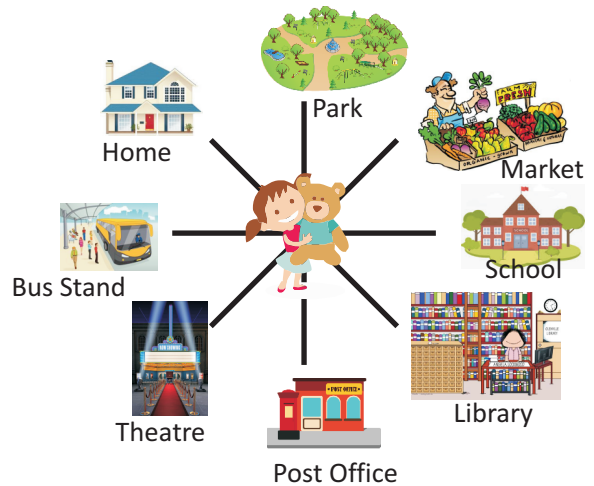

- a) West b) East
c) North west d) North

10. If 'Green' is called 'Blue', 'Blue' is called 'Yellow' and 'Yellow' is called 'White', what is the colour of sky?

- a) White b) Blue
c) Yellow d) Green

11. Replace the question mark with a suitable number.

$$4 \times 8 + 3 = 6 \times \square - 1$$

- a) 5 b) 6 c) 7 d) 4

12. Find the mirror image if the mirror is placed vertically to the right.

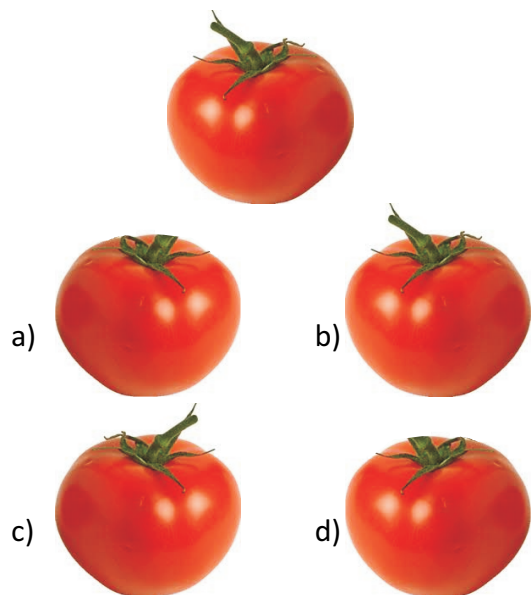

13. Lisa is standing 9th from top in a queue. There are 17 persons behind her. What is her position from bottom?

- a) 26 b) 18 c) 20 d) 19

14. What will come next?

Y2B X3C W4D V5E

- a) U67 b) T7F c) U6F d) U7G

15. In certain code, STAY is written as \$%^! and COST is written as %0!. How will you write TOY using the same code?

- a) \$0% b) %0! c) #^% d) *0%

SECTION B : MATHEMATICAL REASONING

16. Tinku is going to attend a scholarship examination. His role number is 245796382. How will he recite his roll number?

- a) Two crore forty five lakh ninety six thousand three hundred and eighty two.
 b) Twenty four crore fifty seven lakh ninety six thousand three hundred and eighty two
 c) Two crore forty five lakh seventy nine thousand six hundred and eighty two.
 d) Twenty four crore fifty lakh seventy nine thousand three hundred and eighty two.

17. Niffin used to go to sea shore every evening. One day he saw lot of sea shells and he started collecting it. He got 2234374 sea shells that day. Next day he collected 1328296 shells and on the third day he collected 3736438 sea shells. Can you find out how many sea shells he collected altogether?

- a) 6103641 b) 7299100
 c) 5288171 d) 7299108

18. 178 boxes contain 6230 mangos. How many mangos can be contained in 99 boxes?

- a) 3465 b) 3430 c) 3366 d) 3332

19. Find the five multiples of 4602?

- a) 9204, 13806, 18408, 23100, 27612
 b) 9204, 13806, 18408, 23010, 27612
 c) 9204, 13806, 18048, 23010, 27612
 d) 9204, 13806, 18408, 23010, 27162

20. Convert $165\frac{7}{8}$ into improper fraction?

- a) $\frac{1327}{8}$ b) $\frac{1163}{8}$
 c) $\frac{1255}{8}$ d) $\frac{1100}{8}$

21. Which one of the following is the correct expanded form for the decimal 500.0398?

- a) $50 + \frac{3}{100} + \frac{9}{1000} + \frac{8}{10000}$
 b) $500 + \frac{3}{100} + \frac{9}{1000} + \frac{8}{10000}$
 c) $50 + \frac{3}{10} + \frac{9}{100} + \frac{8}{1000}$
 d) $500 + \frac{3}{10} + \frac{9}{100} + \frac{8}{1000}$

22. Find the percent of sum of and ?

- a) 530% b) 470% c) 106% d) 317%

23. Compare 3:4 and 5:8 and find which one is smaller?

- a) 3:4 b) 5:8
 c) both are equal d) either (a) or (b)

24. Find the Fahrenheit equivalent of 43°C ?

- a) 113.5°F b) 111.7°F
 c) 109.4°F d) 105.6°F

25. By selling a bicycle for ₹19740 Jojo gains ₹4587. How much did he pay for the cycle ?

- a) ₹ 15153 b) ₹ 16893
 c) ₹ 14852 d) ₹ 13755

26. If the $\angle RSQ$ is equal to 90° , then the $\angle TSQ$ is _____

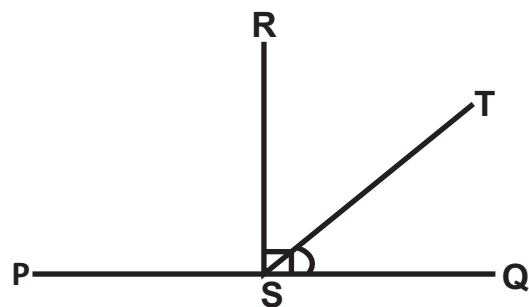

- a) Acute angle b) Obtuse angle
 c) Right angle d) Straight angle

27. The following figure shows the outline of a school compound. Find the perimeter of the school compound?

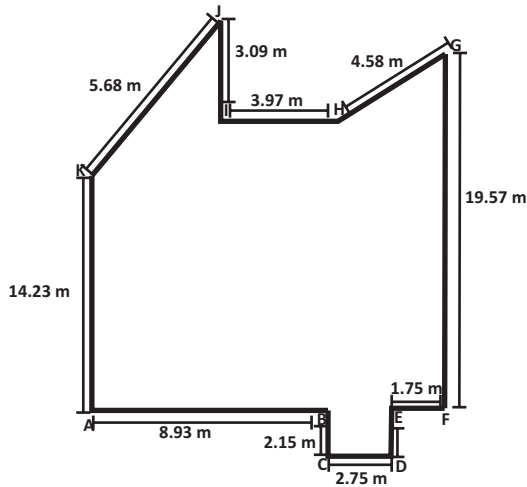

- a) 69.15 m b) 68.85 m
c) 69.65 m d) 70.05 m

28. Dolly made a profit of ₹5876 on selling a painting for ₹32108. Find the cost price of the painting?

- a) ₹26232 b) ₹25332
c) ₹26925 d) ₹26430

29. If 13 workers can paint a house in 24 days, how long it will takes to complete painting if there are only 8 workers?

- a) 27 b) 33 c) 39 d) 45

30. Johnny and family went to watch circus. There are totally 23 members in the family excluding Johnny. The cost of one ticket is 17.618. Can you find how much amount Johnny have to pay?

- a) 405.214 b) 4052.14
c) 422.832 d) 4228.32

31. What least number should be subtracted from 2673991057 so that the number becomes exactly divisible by 9?

- a) 1 b) 2 c) 3 d) 4

32. Find the value of x in

$$[{\{(22152 \div 13) \times 5\} \times (1136 \times 12) \div (19638 - 2598)}] = x + (7 \times 213)$$

- a) 25 b) 49 c) 57 d) 83

33. A hostel has 21 rooms. Each room can accommodate 12 students at a time. If there are 756 students then how many more rooms are needed to accommodate all the students?

- a) 32 b) 42 c) 52 d) 62

Directions (34 - 35) : The following table shows the list of items in a school store. Study the table carefully and answer the following questions?

Items	Tally mark
Pen	
Pencil	
Note book	
Text book	
Ruler	
Ink Bottle	

34. Which item has the largest count?

- a) Note book b) Pencil
c) Pen d) Text book

35. How many ink bottles and pens are there in the shop altogether?

- a) 53 b) 60
c) 61 d) 62

SECTION C : EVERYDAY MATHEMATICS

36. Rohan bought 5876 g of rice on Monday, 3956 g on Tuesday, 7589 g on Wednesday, 6.876 kg on Thursday and 4003 g on Friday. Find out how much kilograms of rice he bought all together?

- a) 26.297 kg b) 28.300 kg
c) 27.865 kg d) 29.050 kg

37. Sudha wrote a number in a paper and asked Midhun to write it in words. The number is 500308702 Midhun was little bit confused. Can you help him to find which one is correct?

- a) Fifty crore three lakhs eight thousand seven hundred and two
- b) Five crore three lakhs eight thousand seven hundred and two
- c) Fifty crore thirty lakhs eight thousand seven hundred and two
- d) Five crore thirty lakhs eight thousand seven hundred and two

38. Balu have a large collection of stamps. He had 57828283 stamps in his collection. On his birthday his father gifted 682349 stamps and his friend gifted 7598235 stamps. Can you find the total number of stamps Balu have now?

- a) 66108687 b) 66480867
- c) 66018867 d) 66108867

39. Sonu planned to construct a wall between the dining room and living area of his house. When he measured he found that the wall must be 48 cm long, 18 cm wide and 26 cm high. If he bought bricks of 6 cm long, 3 cm wide and 4 cm high, find out how many bricks are required to build the wall?

- a) 210 b) 278 c) 312 d) 395

40. Sajan bought 32 garlands for a function. He paid ₹ 80000 to the shop keeper. The shopkeeper returned his ₹440 and 4 candies each worth 2. Find the cost of each garland?

- a) ₹ 2486 b) ₹ 2590 c) ₹ 2726 d) ₹ 2892

41. Rohit bought 3894 bags from a shop each cost ₹156.38. Find the total cost he has to pay?

- a) ₹ 608943.72 b) ₹ 624581.27
- c) ₹ 645742.02 d) ₹ 660666.38

42. According to the calculation of the municipality, 1300 people attended yesterday's seminar. In which 27% are children's, 16% are old aged people, 35% are youth and remaining are teenaged people. Can you help them to find the total number of youths

and teenaged people who attended the seminar?

- a) 684 b) 559 c) 455 d) 741

43. Sharon is distributing pens equally among the students of her class. She has 16 red pens, 24 blue pens, and 32 black pens. Can you find the greatest number of pens each student will get?

- a) 9 b) 8 c) 7 d) 6

44. The water tank of Sneha's house can hold 658 litres of water. One day Sneha filled 283512 millilitres of water into it. Find out how many more liters of water is needed to fill the tank completely?

- a) 339.848 l b) 249.884 l
- c) 576.808 l d) 294.488 l

45. Out of ₹38985, Hima spend 21% for food, 13% for paying electricity bills and 25.6% for health care. She saved the remaining money for future uses. Find out how much money he spends for health care?

- a) ₹ 11059.58 b) ₹ 8524.32
- c) ₹ 9980.16 d) ₹ 10684.85

SECTION D : ACHIEVERS SECTION

46. Find (P+Q-S+R) T in

$$\begin{array}{r}
 25P4 \\
 \times 3Q62 \\
 \hline
 5168 \\
 15R04 \\
 1808S \\
 7752 \\
 \hline
 T721008
 \end{array}$$

- a) 88 b) 108 c) 124 d) 158

47. A big square is made up of 64 small squares. After removing some small squares from the big square, the given figure is obtained. The length of a small square is 2.85 cm. Find the total area of the squares removed?

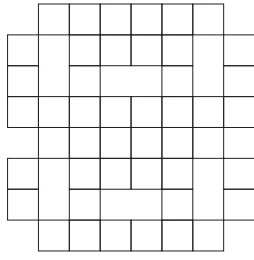

- a) 102.6 sq cm b) 141.12 sq cm
c) 146.205 sq cm d) 156.645 sq cm

48. Find the number of right angles in the given figure?

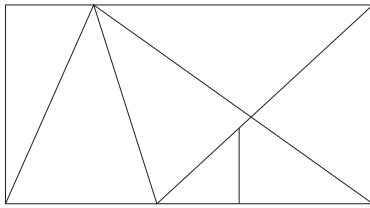

- a) 4 b) 5 c) 6 d) 7

49. Diya said Riya that she is thinking about a number, if Riya find it correctly, then she will give the chocolates to Riya. The Hints are, it's a five digit number. The hundred's place digit is an even prime number. The ten thousands digit is the highest common factor of 12 and 32. The one's place digit is the largest common multiple of ten thousand's place digit and hundred's place digit. The thousand's place digit is the smallest odd number. There are two odd digits in the number. Find the number?

- a) 41234 b) 41284
c) 61234 d) 61294

50. Rosy borrowed ₹25984 from Jolly last month. Rosy gave back ₹7125 on 2nd of this month and ₹5964 by half of this month. On 24th Rosy borrowed ₹3888 again from Jolly. Find out how much money she has to give to Jolly?

- a) ₹12895 b) ₹13964
c) ₹17053 d) ₹16783

ANSWERS

- | | | | |
|--------|--------|--------|--------|
| 1. c) | 2. c) | 3. a) | 4. a) |
| 5. b) | 6. b) | 7. d) | 8. b) |
| 9. b) | 10. c) | 11. b) | 12. c) |
| 13. b) | 14. c) | 15. b) | 16. b) |
| 17. d) | 18. a) | 19. b) | 20. a) |
| 21. b) | 22. a) | 23. b) | 24. c) |
| 25. a) | 26. a) | 27. b) | 28. a) |
| 29. c) | 30. c) | 31. d) | 32. a) |
| 33. b) | 34. d) | 35. a) | 36. b) |
| 37. a) | 38. d) | 39. c) | 40. a) |
| 41. a) | 42. d) | 43. a) | 44. d) |
| 45. c) | 46. b) | 47. c) | 48. b) |
| 49. a) | 50. d) | | |